

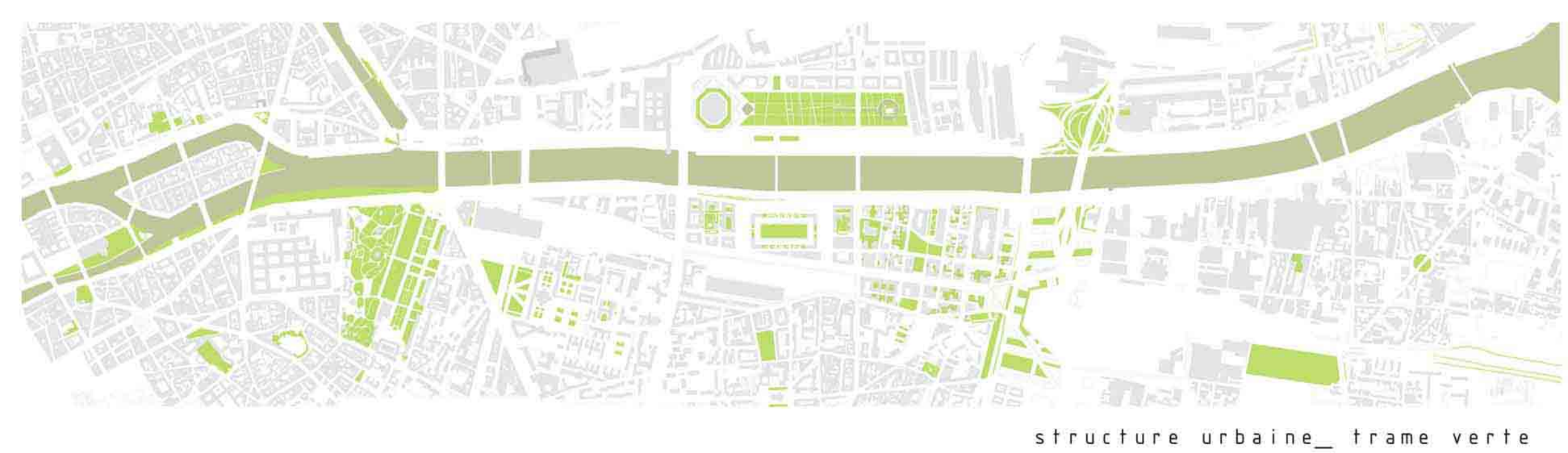

ZAC Paris rive gauche\_vue de la tour Eiffel

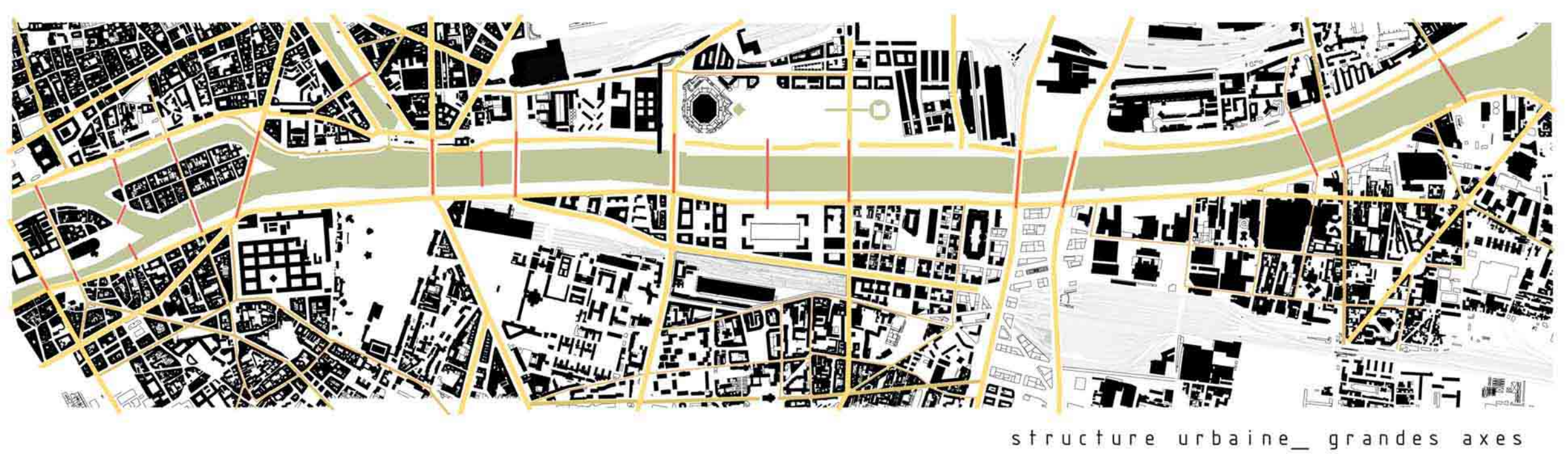

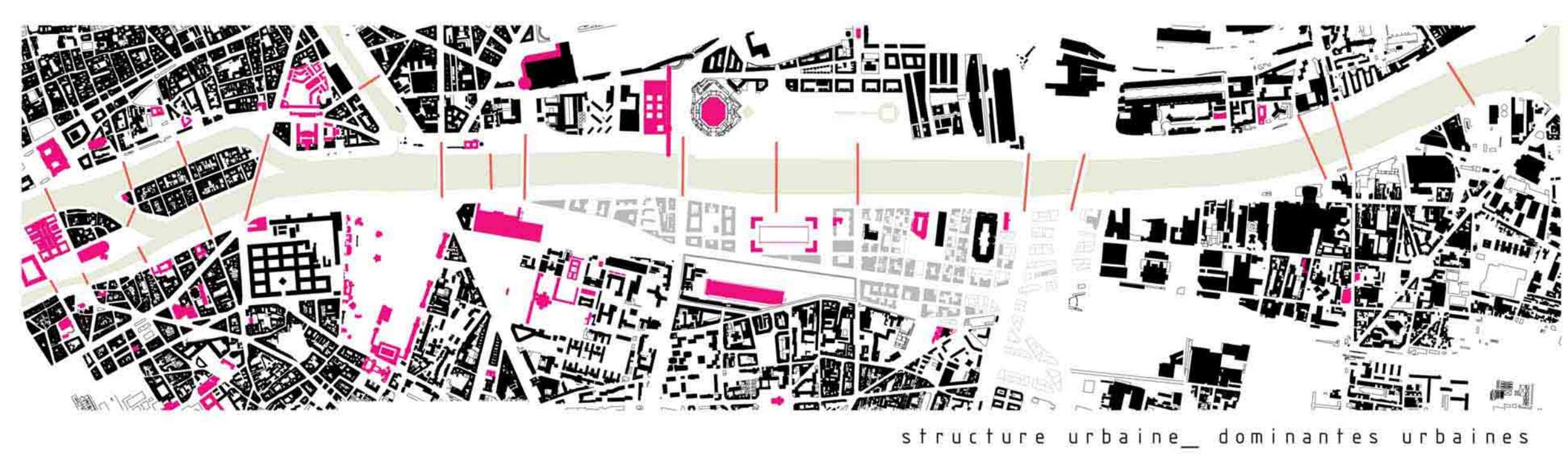
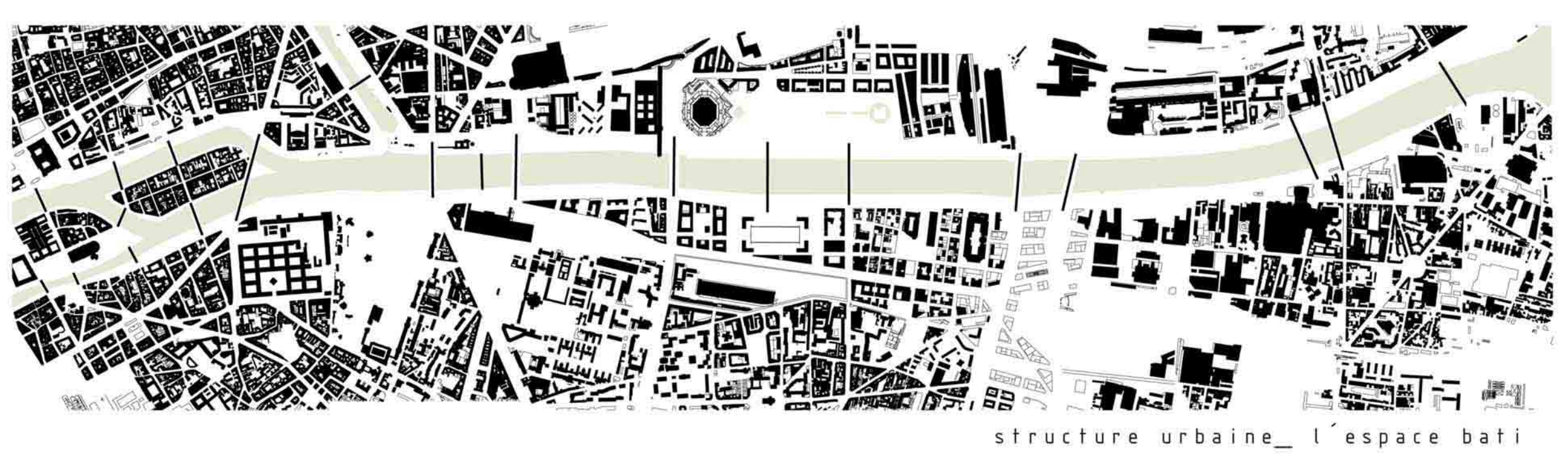
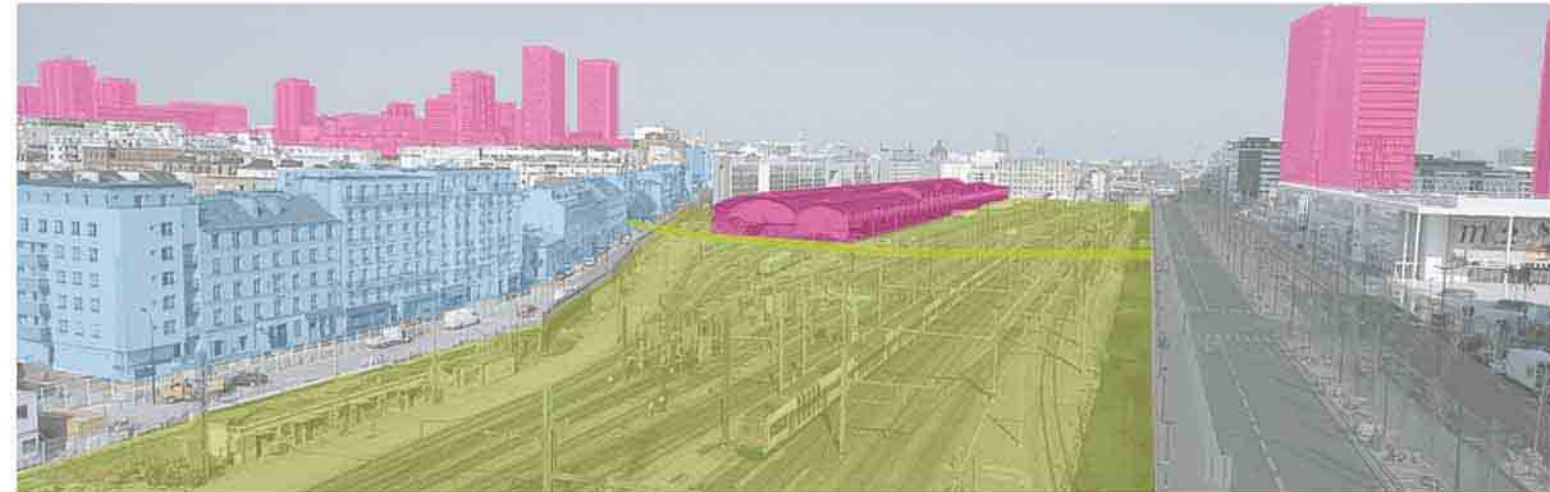
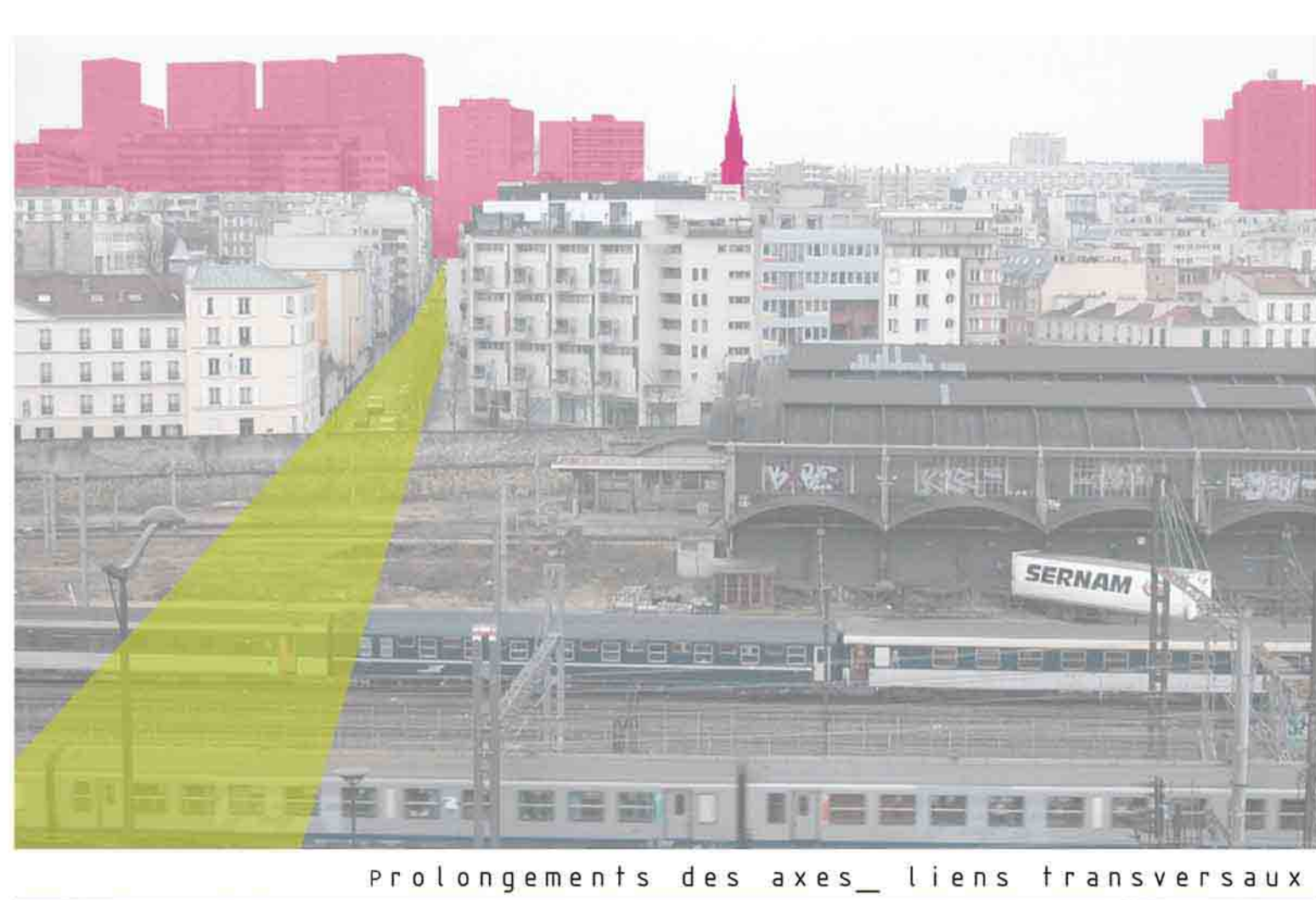
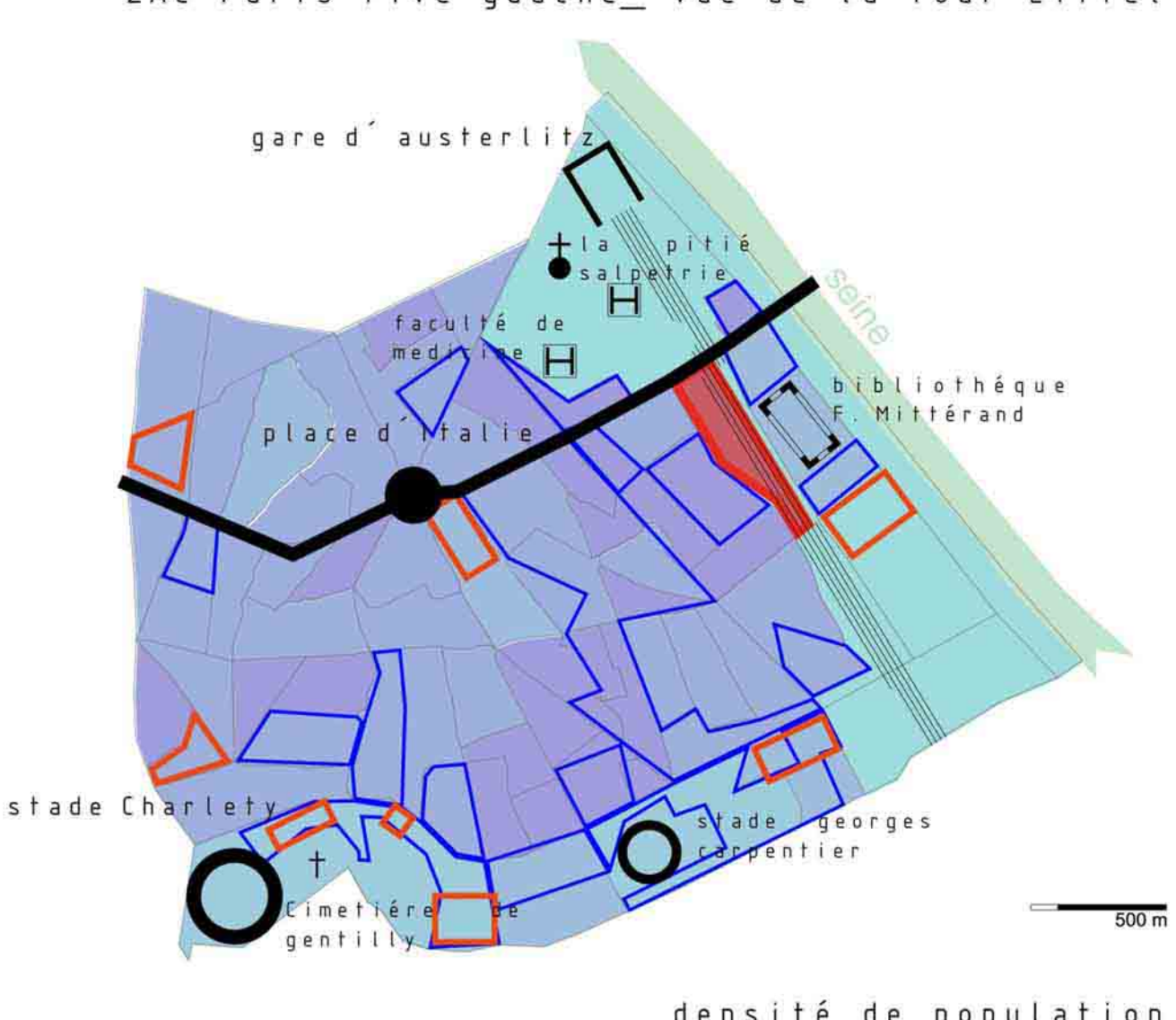
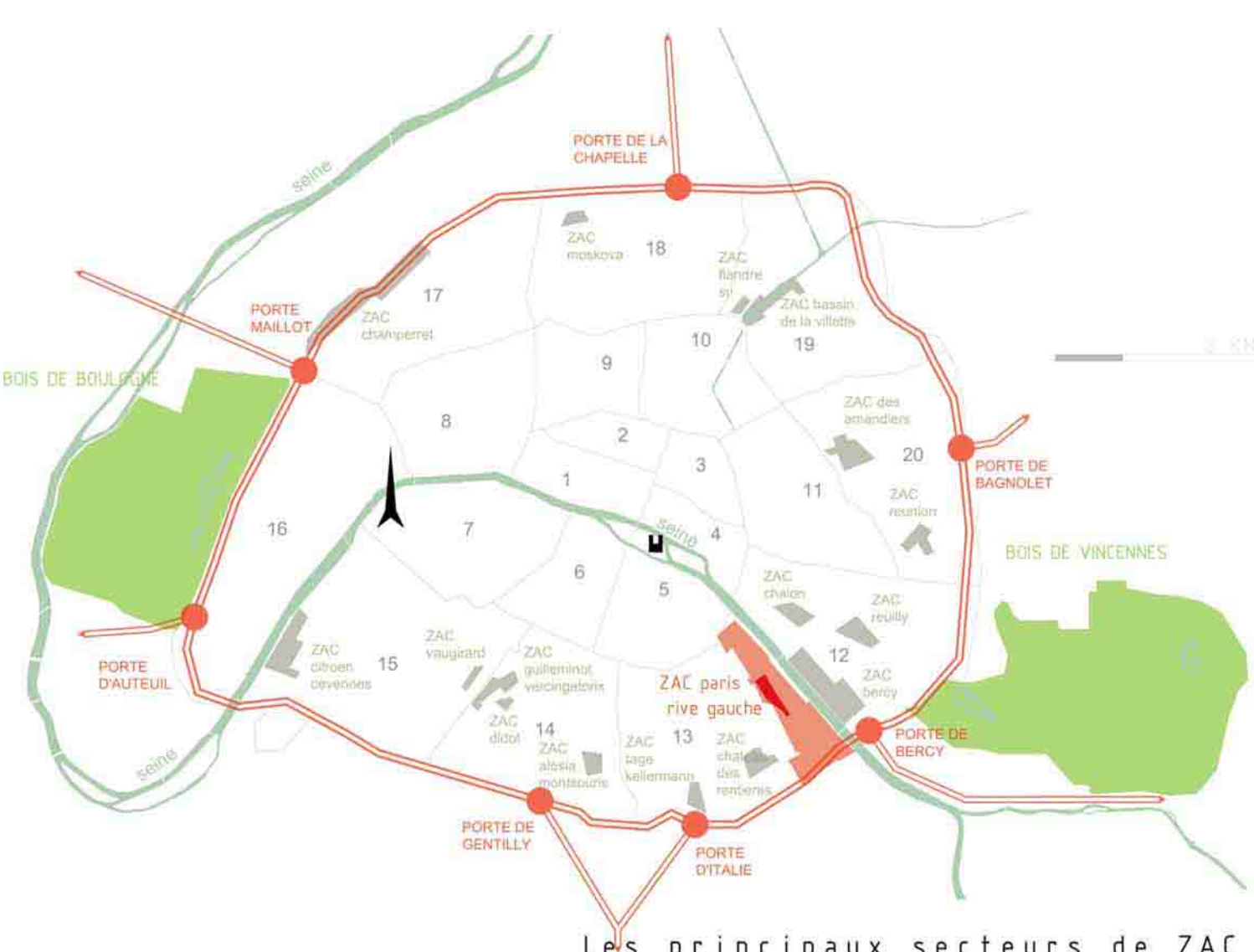
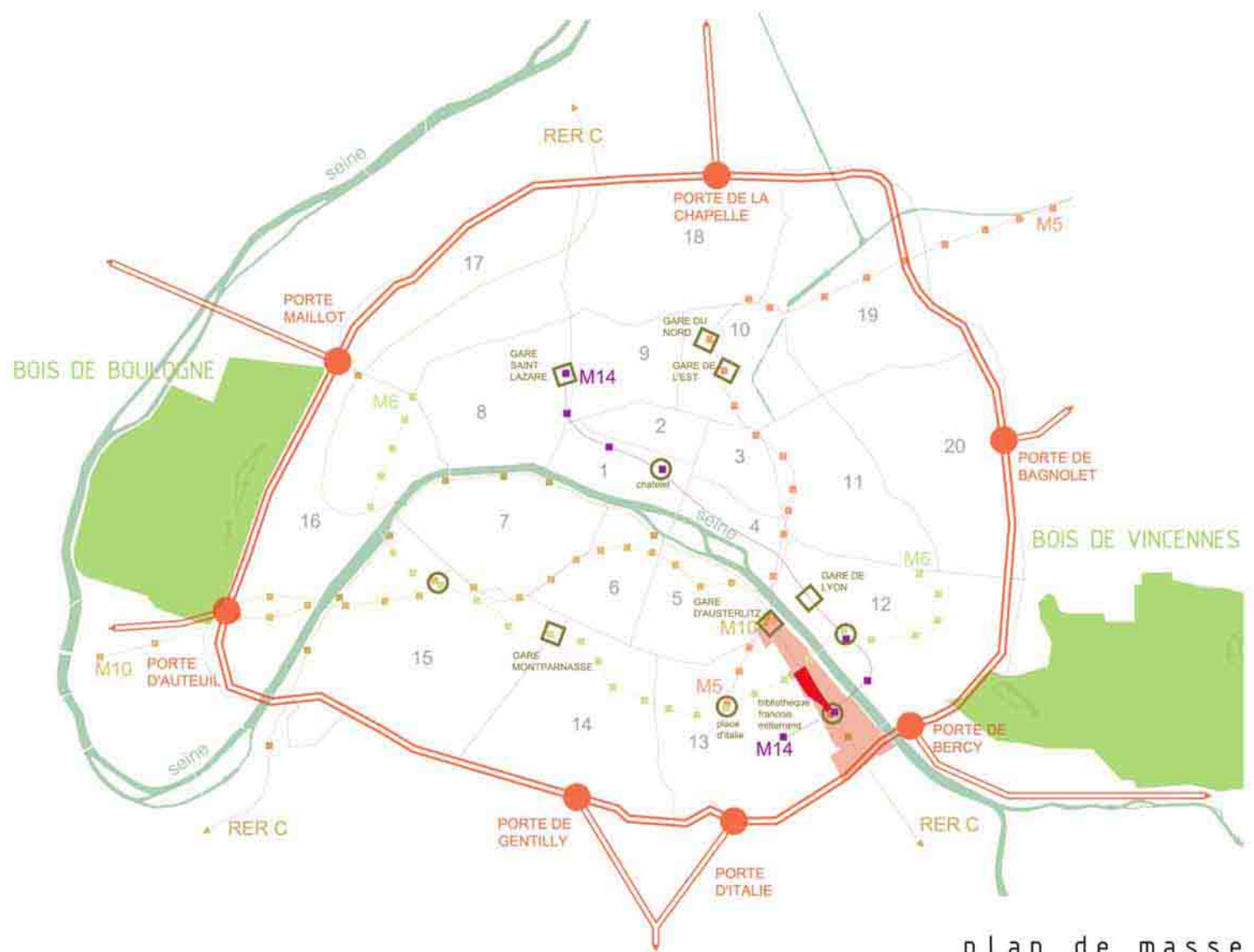
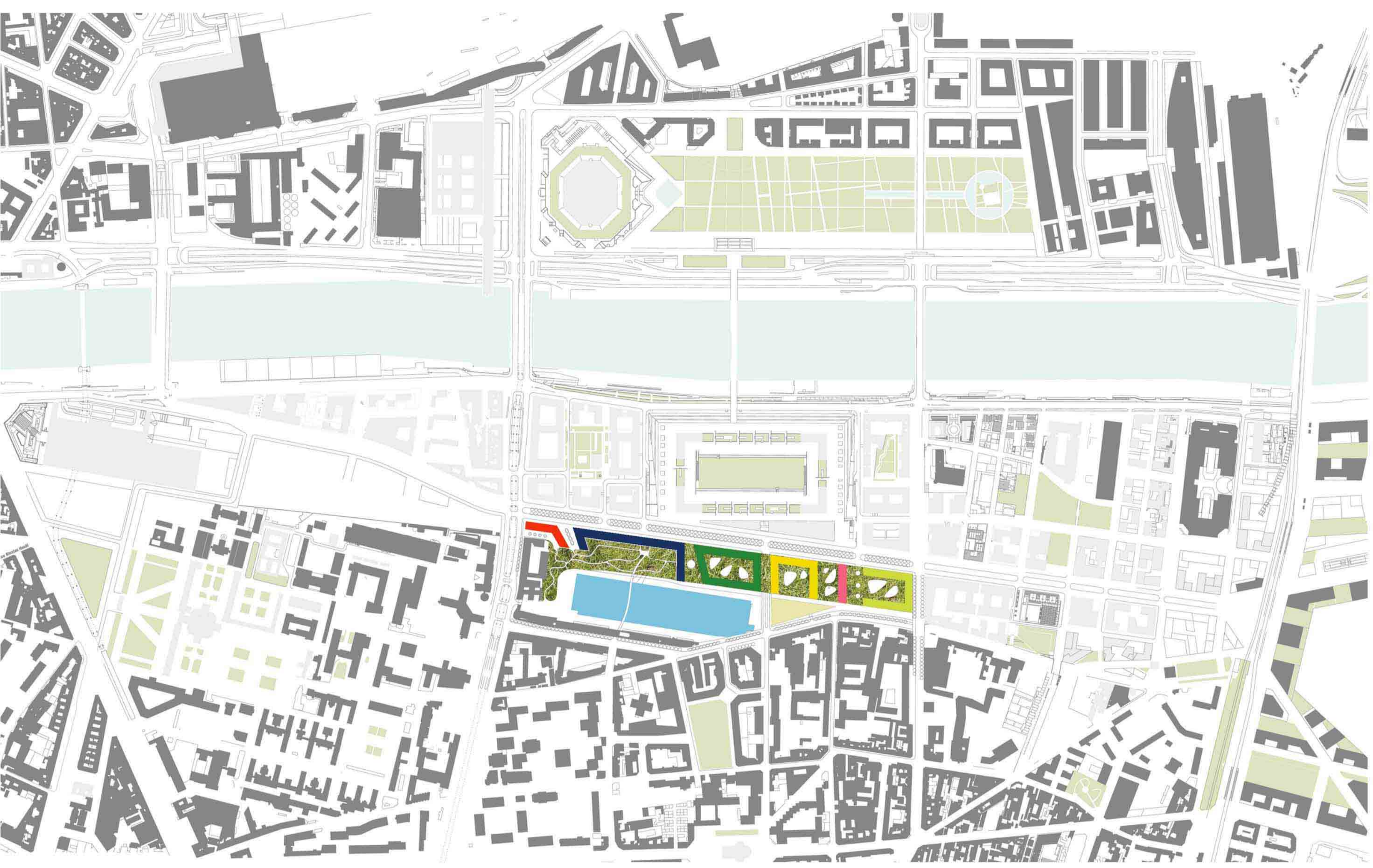

plan de situation 1:5000

Fonctionnement

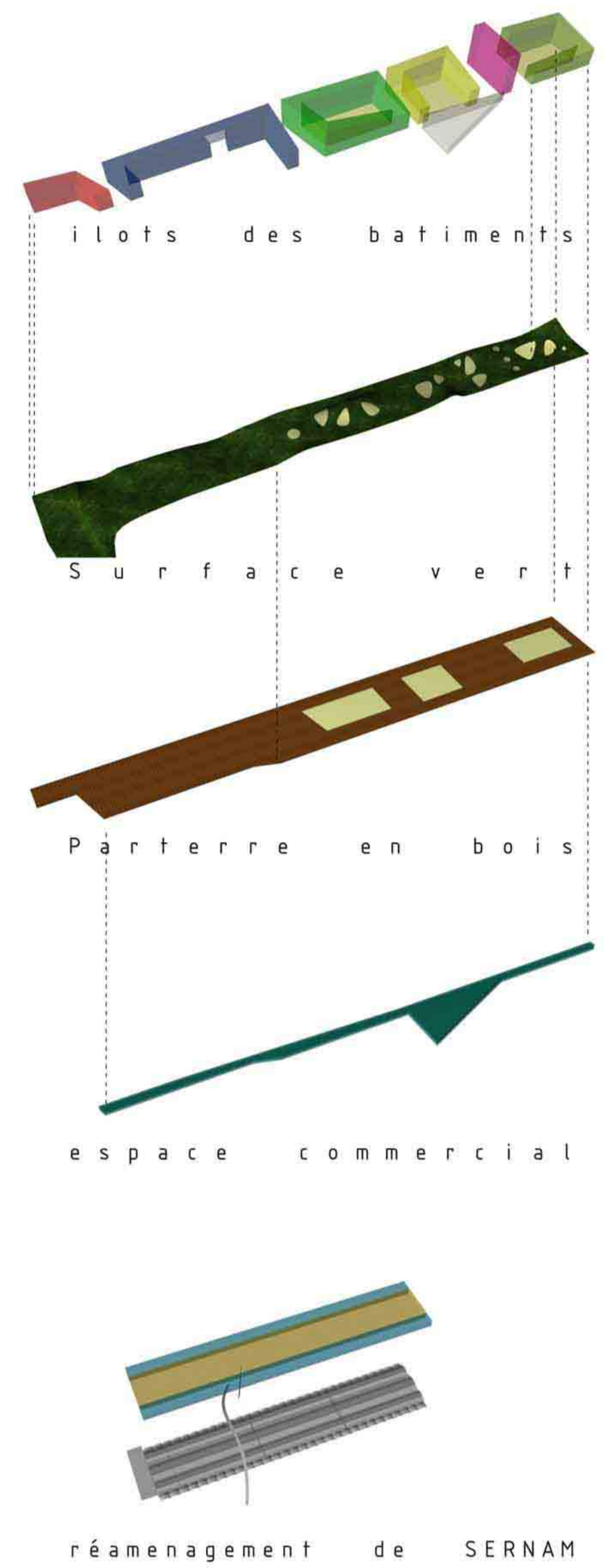

plan de parterre commercial\_ 1:2000

- espace public - en bois  
commerce, activités — 20 000 m2
- bureaux — 13 500 m2
- espaces sportifs a implanter dans  
la halle SERNAM
- parterre en bois  
parc paysager — 16 000 m2
- commerce, activités — 25 000 m2
- espace sportif \_ dans SERNAM
- aire de stationnement — 30 000 m2
- SERNAM — gymnase, terrain d'  
éducation physique, équipement  
culturel, commerce

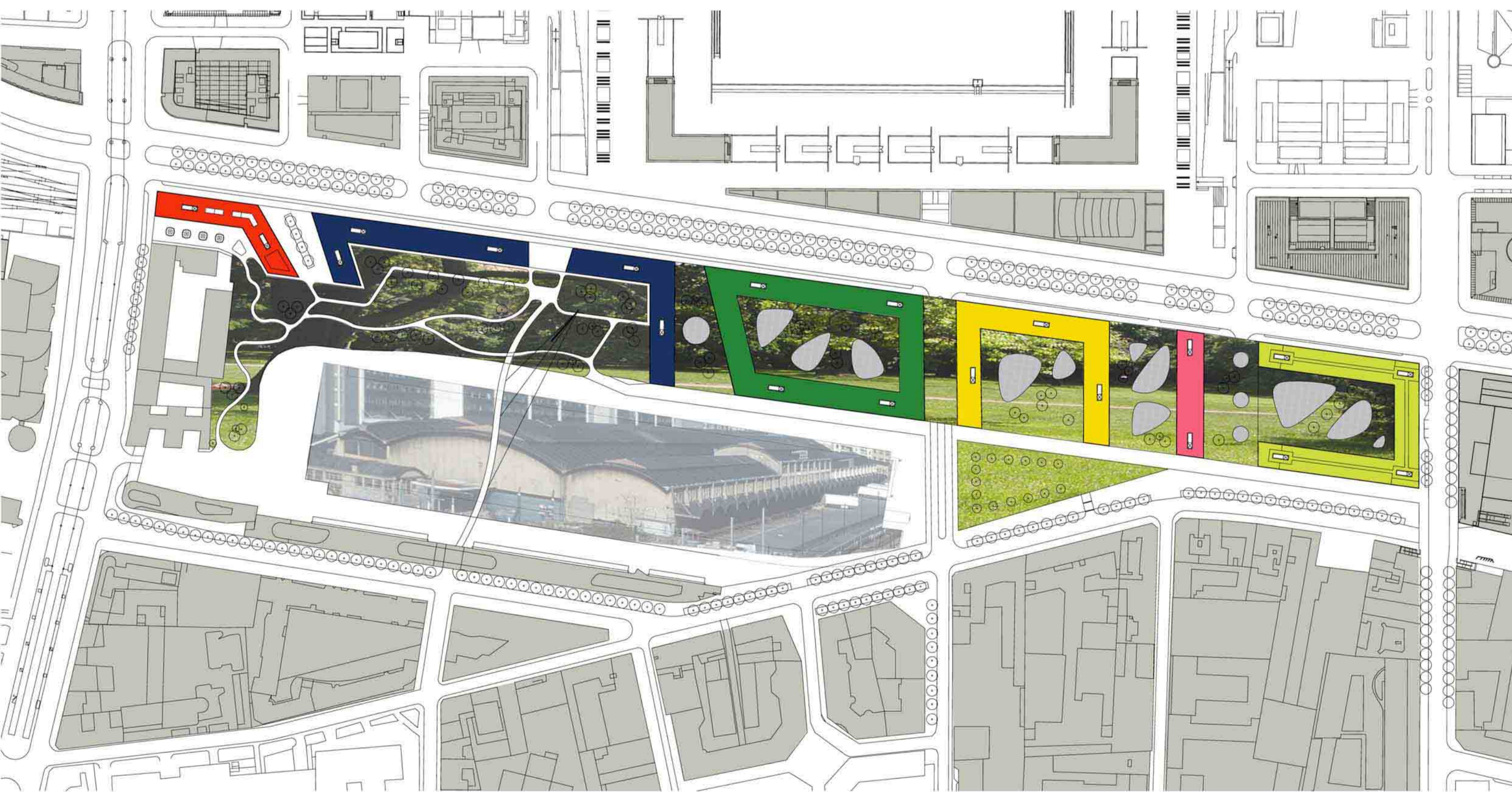
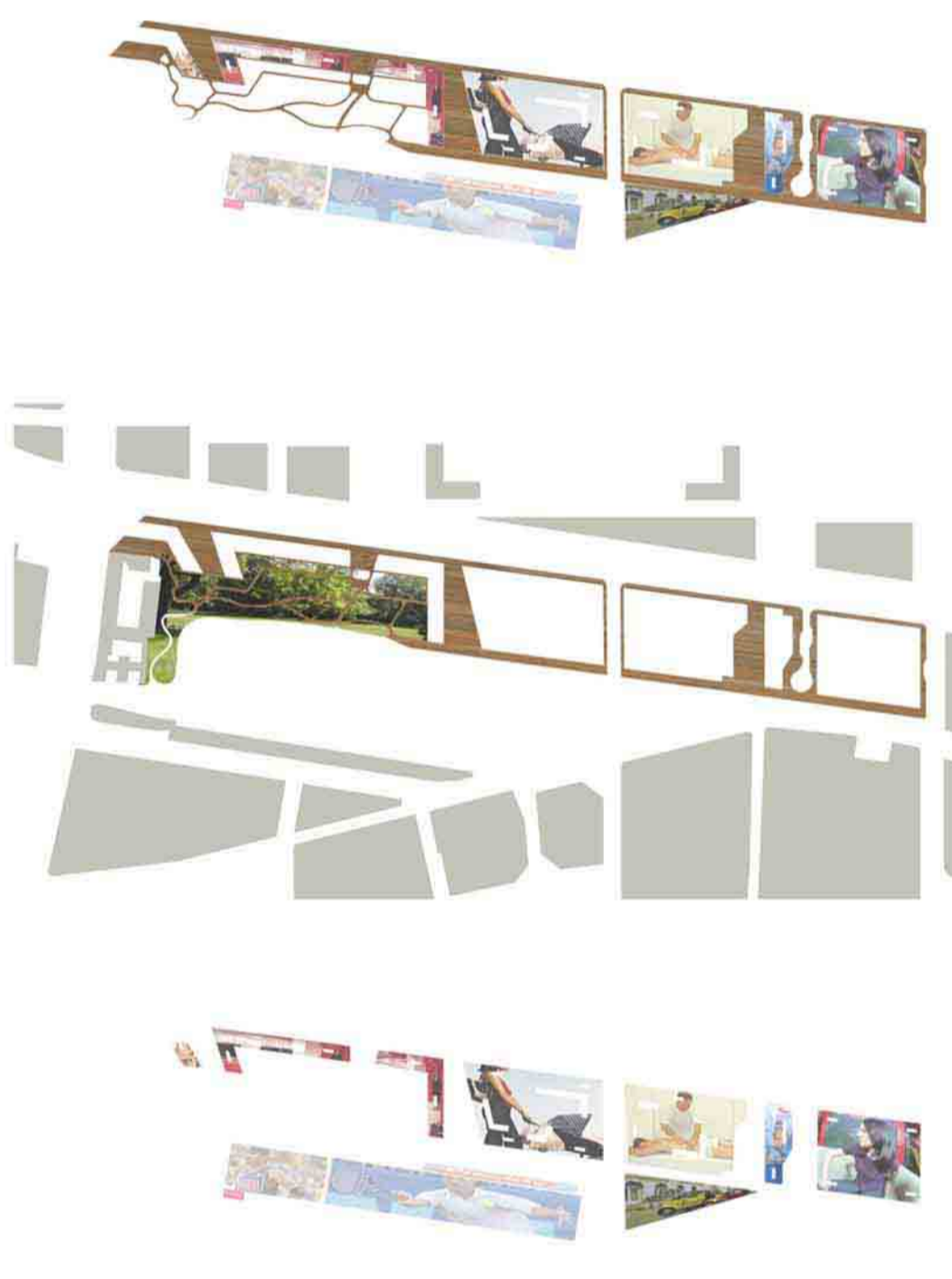

plan de niveau courant\_ 1:2000

- parc paysager  
jardins semi privés — 16 000 m2
- 10 000 m2
- logement  
block bleu — 32 000 m2
- block vert — 30 000 m2
- block jaune — 20 000 m2
- block rosé — 17 000 m2
- block vert2- hotel — 23 000 m2

parc paysager, jardins

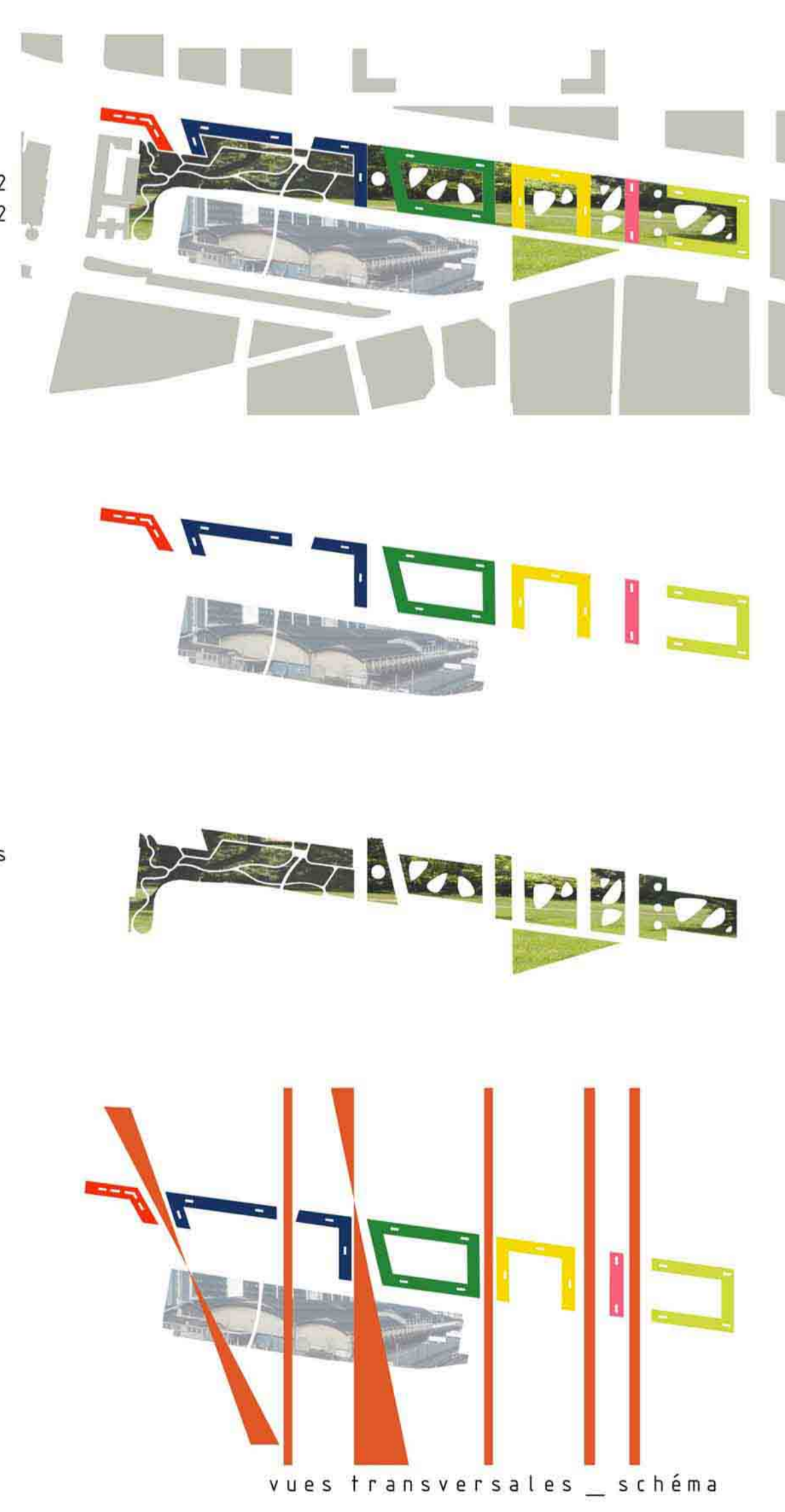

vues transversales \_ schéma

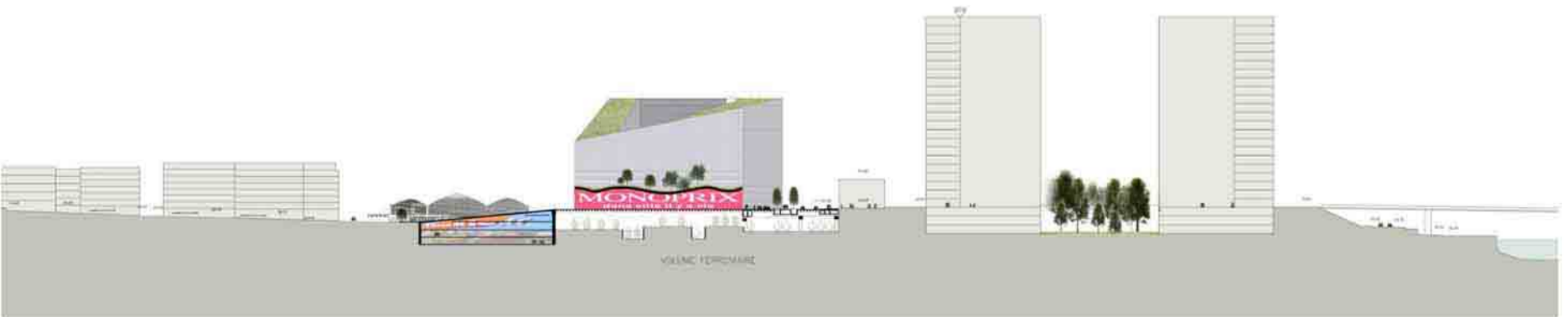

coupe transversale \_ 1:2000



vue sur l'avenue de France du côté de nouvel hotel



vue sur le parc du côté de SERNAM



vue sur l'avenue de France du côté Vincent Auriol



vue sur l'îlot de logement vers le parc - café en haut



vue du passerelle piétonne



vue sur la passerelle piétonne projeté et le parc

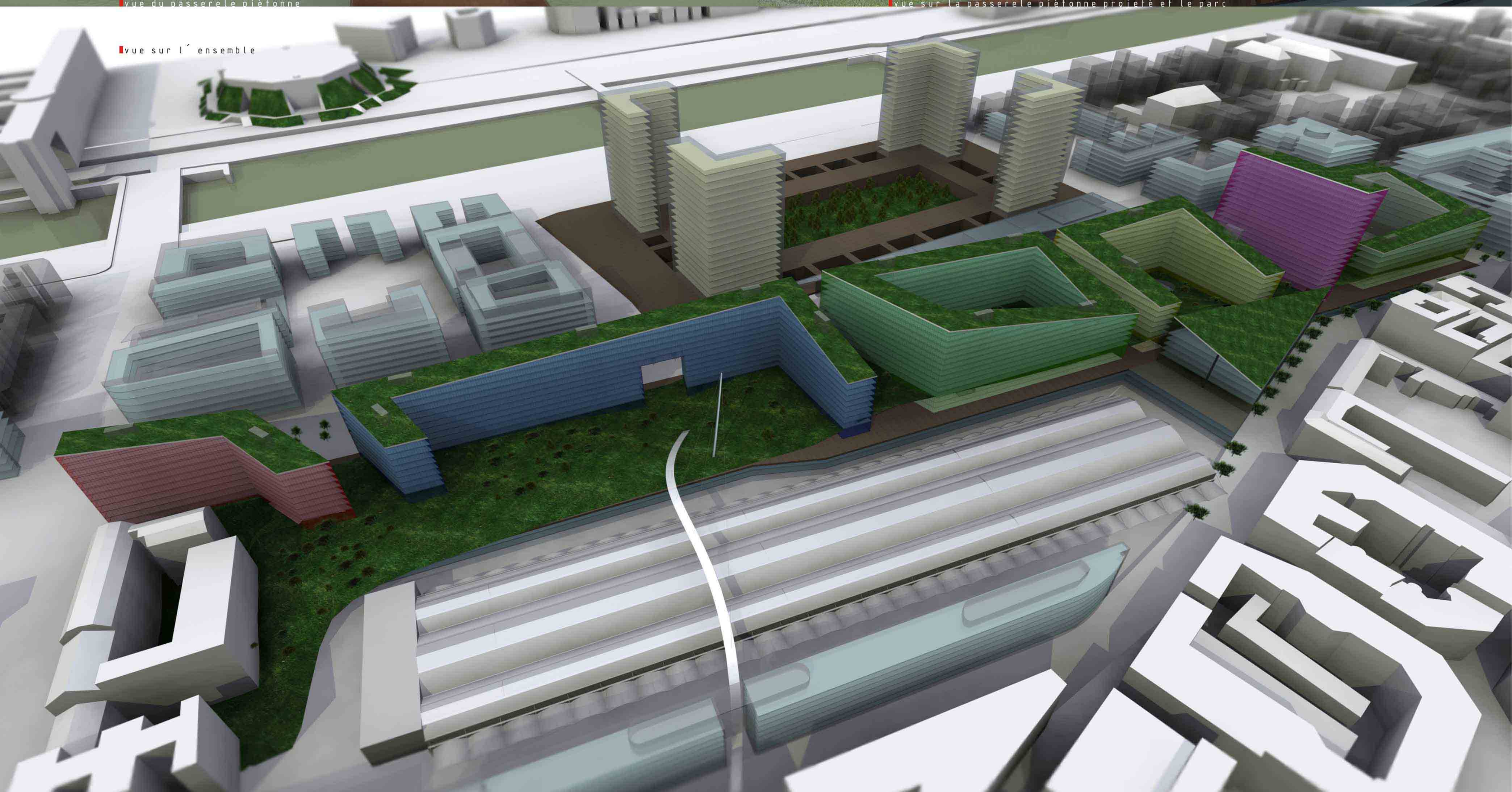

vue sur l'ensemble